

HOME PROJECT

design — Giuseppe Bavuso

Off-Shore system

ALIVAR

ITALIAN DESIGN CULTURE

OFF-SHORE è un sistema di ultima generazione ad alto contenuto di design e tecnologia che offre un panorama infinito di possibilità. Facile da modificare e trasformare; la grande flessibilità dei suoi moduli diventa la vera rivoluzione di questo sistema in grado di disegnare spazi domestici sempre diversi, flessibili ma in saldo equilibrio tra forza e leggerezza, non trascurando la ricerca tecnica e creando con semplicità il new concept del living_

The OFF-SHORE SYSTEM is a latest-generation system that features luxurious design, high-tech content and an infinity of possibilities. Easy to modify and transform, this system is a real revolution: it features highly flexible modules and can accommodate a multitude of domestic spaces. Its adaptability is built on a well-engineered balance between strength and lightness, which integrates the latest technology into a new concept of living_

DAY AREA
OFF-SHORE

Design by Giuseppe Bavuso



OFF-SHORE

Caratterizzato da un estremo eclettismo progettuale, OFF SHORE diventa un contenitore universale da collocare in totale libertà: privo di schemi predefiniti, è in grado di integrarsi pienamente con l'architettura di casa e la sua personalità stilistica

Characterised by the ultimate in eclectic design, OFF-SHORE is a universal container that can be positioned in complete freedom: it is a fluid system without boundaries that will fit perfectly into any home, any style and any type of architecture.





OFF-SHORE è un sistema di ultima generazione ad alto contenuto di design e tecnologia che offre un panorama infinito di possibilità. Facile da modificare e trasformare; la grande flessibilità dei suoi moduli diventa la vera rivoluzione di questo sistema in grado di disegnare spazi domestici sempre diversi, flessibili ma in saldo equilibrio tra forza e leggerezza, non trascurando la ricerca tecnica e creando con semplicità il new concept del living.

The OFF-SHORE SYSTEM is a latest-generation system that features luxurious design, high-tech content and an infinity of possibilities. Easy to modify and transform, this system is a real revolution: it features highly flexible modules and can accommodate a multitude of domestic spaces. Its adaptability is built on a well-engineered balance between strength and lightness, which integrates the latest technology into a new concept of living.



La retro illuminazione LED delle mensole in MDF, nelle finiture laccato lucido o opaco, nei colori bianco, tortora o noce Canaletto, oltre ad un utilizzo pratico, valorizza la composizione e la rende parte creativa dell'arredamento_

The LED backlighting featured in the MDF shelving, which comes in white, dove-grey or Canaletto walnut with either a glossy or matt lacquer finish, is not only a practical addition but also adds value to the composition, making it a creative part of the furnishings_







Contenitori orizzontali porta DVD in alluminio anodizzato naturale, titanio o laccato bianco dove riporre e organizzare la musica o i film. Funzionalità ed estetica per oggetti di uso quotidiano_

Horizontal DVD storage units in natural anodized aluminium, titanium or white lacquer are perfect for storing and organising your music and films and add a touch of functionality and aesthetic appeal to everyday objects_







Cassettone in appoggio per vari componenti audio-video. Capiente cassetto, portaoggetti dotato di canalina in alluminio anodizzato che nasconde il passaggio dei cavi.

Storage drawer for audio and video components. Spacious container with anodized aluminium raceway to hide cables and house video and audio equipment.





Le mensole in MDF laccato lucido o opaco, in bianco, tortora o in noce Canaletto, illuminate da LED diventano dettagli squisiti dove l'essenzialità lascia spazi aperti_

The white, dove-grey or Canaletto walnut MDF shelves, which feature a glossy or matt lacquer finish and LED backlighting, offer an exquisitely simple touch that can enhance space without cluttering it_







OFF-SHORE

PANNELLI PANELS

Pannellatura in MDF laccato lucido o opaco nei colori bianco 9016 o tortora 05.70. Illuminazione LED. Attacco a parete regolabile. Piedini regolabili.

Panel in MDF, glossy or matt lacquered, available in white 9016 or dove brown 05.70 colors. LED lighting. Adjustable wall-fixing. Adjustable feet.

Pannelli. Panels.

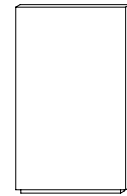

Art. OSP110 / OSP110
L/W 110 H 220 P/D 13.2
W 43.3" H 86.6" D 5.2"

Art. OSP130 / OSP130
L/W 130 H 220 P/D 13.2
W 51.2" H 86.6" D 5.2"

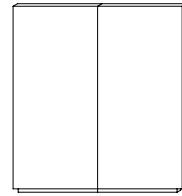

Art. OSP220 / OSP220
L/W 220 H 220 P/D 13.2
W 86.6" H 86.6" D 5.2"

BASAMENTI BASES

Basamento in MDF laccato lucido o opaco, nei colori bianco 9016 o tortora 05.70. Piedini regolabili.

Base in MDF, glossy or matt lacquered, available in white 9016 or dove brown 05.70 colors. Adjustable feet.

Basamenti. Bases.



Art. OSB110
L/W 110 H 12 P/D 55
W 43.3" H 4.7" D 21.6"



Art. OSB130
L/W 130 H 12 P/D 55
W 51.2" H 4.7" D 21.6"

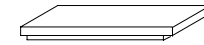

Art. OSB150
L/W 150 H 12 P/D 55
W 59" H 4.7" D 21.6"

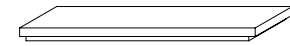

Art. OSB220
L/W 220 H 12 P/D 55
W 86.6" H 4.7" D 21.6"

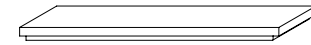

Art. OSB240
L/W 240 H 12 P/D 55
W 94.5" H 4.7" D 21.6"

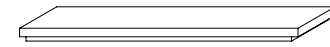

Art. OSB260
L/W 260 H 12 P/D 55
W 102.4" H 4.7" D 21.6"

BASAMENTI PER PORTE SCORREVOLI BASES FOR SLIDING DOORS

Basamento predisposto per porta scorrevole in MDF laccato lucido o opaco, nei colori bianco 9016 o tortora 05.70. Piedini regolabili.

Base arranged for sliding doors, in MDF, glossy or matt lacquered, available in white 9016 or dove brown 05.70 colors. Adjustable feet.

Basamenti per porte scorrevoli. Bases for sliding doors.

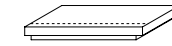

Art. OSBS110
L/W 110 H 12 P/D 55
W 43.3" H 4.7" D 21.6"

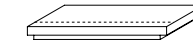

Art. OSBS130
L/W 130 H 12 P/D 55
W 51.2" H 4.7" D 21.6"

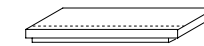

Art. OSBS150
L/W 150 H 12 P/D 55
W 59" H 4.7" D 21.6"



Art. OSBS220
L/W 220 H 12 P/D 55
W 86.6" H 4.7" D 21.6"

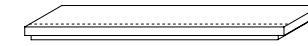

Art. OSBS240
L/W 240 H 12 P/D 55
W 94.5" H 4.7" D 21.6"



Art. OSBS260
L/W 260 H 12 P/D 55
W 102.4" H 4.7" D 21.6"

Binario. Glide.



Art. OSBA100
Binario per porta scorrevole in alluminio anodizzato naturale, lunghezza massima mt. 6.

Glide for sliding door in anodised natural aluminium, maximum length mt. 6.

MENSOLE SHELVES

Mensola in MDF laccato lucido o opaco nei colori bianco 9016, tortora 05.70 o in noce Canaletto. Illuminazione LED.

Shelf in MDF, glossy or matt lacquered available in white 9016, dove brown 05.70 or in Canaletto walnut. LED lighting.

Mensole. Shelves.



Art. OSR93 / OSRI93
L/W 93 H 5 P/D 27
W 36.6" H 2" D 10.6"



Art. OSR113 / OSRI113
L/W 113 H 5 P/D 27
W 44.5" H 2" D 10.6"

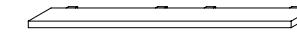

Art. OSR203 / OSRI203
L/W 203 H 5 P/D 27
W 79.9" H 2" D 10.6"

OFF-SHORE

VETRINE CABINETS

Vetrina in MDF laccato lucido o opaco nei colori bianco 9016 o tortora 05.70. Anta in cristallo trasparente o fumé. Cornice in alluminio anodizzato bianco, naturale o titanio.

Cabinet in MDF, glossy or matt lacquered, available in white 9016 or dove brown 05.70. Door in glass either clear or smoke-grey. Aluminium edge either white, natural or titanium.

Vetrine. Cabinets.

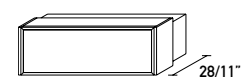

Art. OSV113
L/W 113 H 38 P/D 28
W 44.5" H 15" D 11"

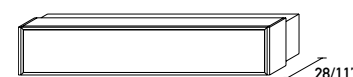

Art. OSV203
L/W 203 H 38 P/D 28
W 79.9" H 15" D 11"

Profondità interna. Inside depth. 23/9"

PORTA DVD DVD UNIT

Porta-DVD in alluminio anodizzato naturale, titanio o laccato bianco.

DVD unit made of anodised aluminium natural, titanium or white painted.

Porta DVD. DVD units.

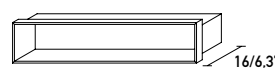

Art. OSDVD93
L/W 93 H 22 P/D 16
W 36.6" H 8.7" D 6.3"

Art. OSDVD103
L/W 103 H 22 P/D 16
W 40.5" H 8.7" D 6.3"

Profondità interna. Inside depth. 14/5.5"

Porta decoder. Decoder unit.

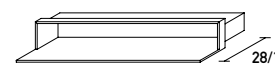

Art. OSDEC93
L/W 93 H 16 P/D 28
W 36.6" H 6.3" D 11"

Art. OSDEC103
L/W 103 H 16 P/D 28
W 40.5" H 6.3" D 11"

Profondità interna. Inside depth. 26/10.2"

CASSETTIERE DRAWER UNITS

Cassettone da appoggio in MDF laccato lucido o opaco nei colori bianco 9016, tortora 05.70 o in noce Canaletto con canalina passacavi in alluminio anodizzato.

Drawer unit in MDF, glossy or matt lacquered in white 9016, dove brown 05.70 or in Canaletto walnut with cables raceways in anodised aluminium.

Cassettiere. Drawer units.

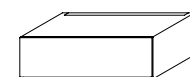

Art. OSC113A
L/W 113 H 35 P/D 40
W 44.5" H 13.8" D 15.7"

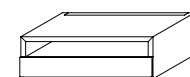

Art. OSC113C
L/W 113 H 35 P/D 40
W 44.5" H 13.8" D 15.7"

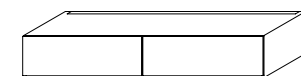

Art. OSC203
L/W 203 H 35 P/D 40
W 79.9" H 13.8" D 15.7"

ANTE SCORREVOLI SLIDING DOORS

Anta scorrevole in cristallo temperato trasparente o fumé, spessore 5mm. completa di telaio in alluminio anodizzato naturale, titanio o verniciato bianco.

Sliding door made of tempered glass, clear or smoke-grey, 5 mm. thick complete with frame in anodised aluminium natural, titanium or painted white.

Ante scorrevoli. Sliding doors.

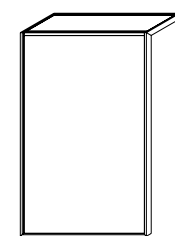

Art. OSAS110
L/W 110 H 213.3 P/D 53.5
W 43.3" H 84" D 21.1"

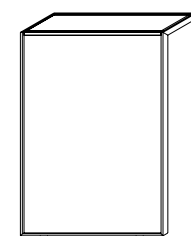

Art. OSAS130
L/W 130 H 213.3 P/D 53.5
W 51.2" H 84" D 21.1"

Binario superiore. Upper glide.



Art. OSBAS00

Binario superiore per anta scorrevole in alluminio anodizzato naturale, lunghezza massima mt. 6.

Upper glide for sliding door in natural anodised aluminium, maximum length mt. 6.

OFF-SHORE

GRIGLIA DI MODULARITÀ GRID MODULARITY

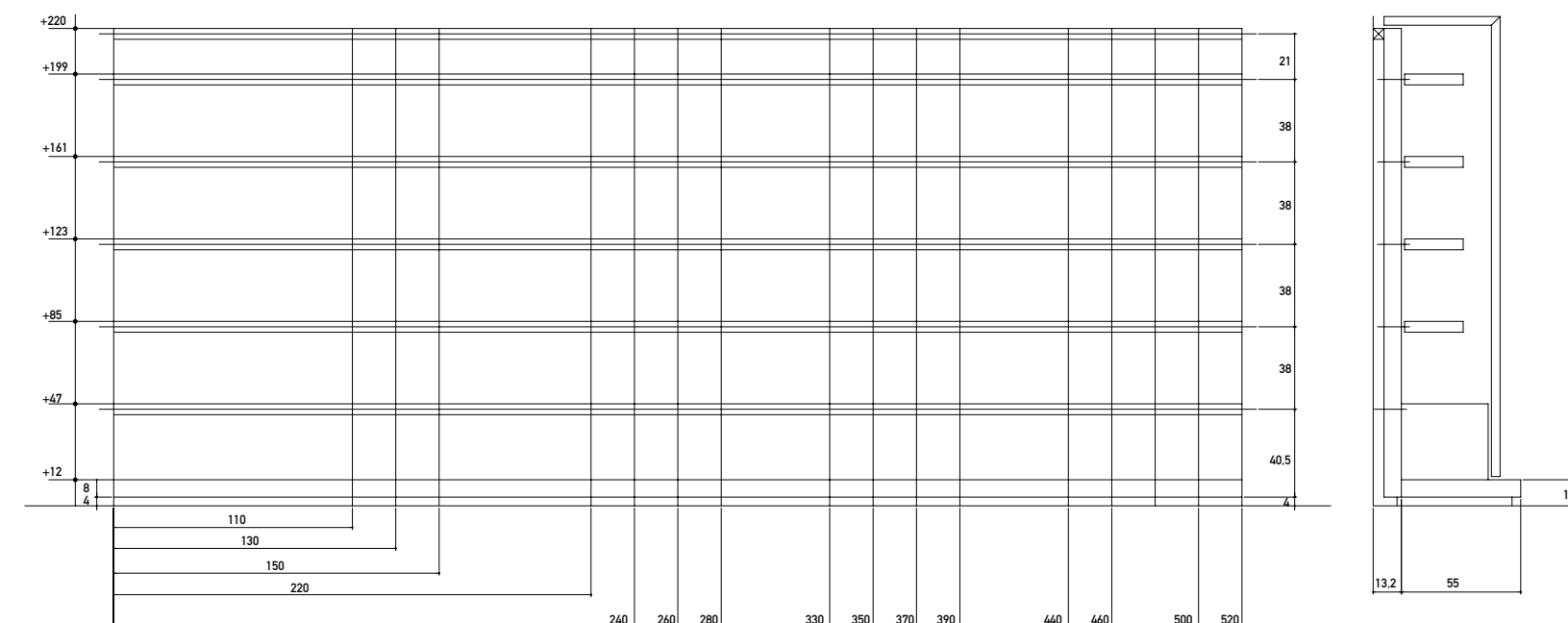

OFF-SHORE

MODULI SINGOLI SINGLE UNITS

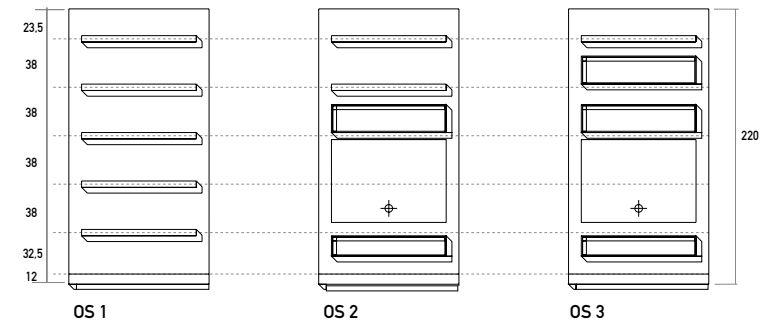

OS 1
L/W 110 H 220
W 43.3" H 86.7"

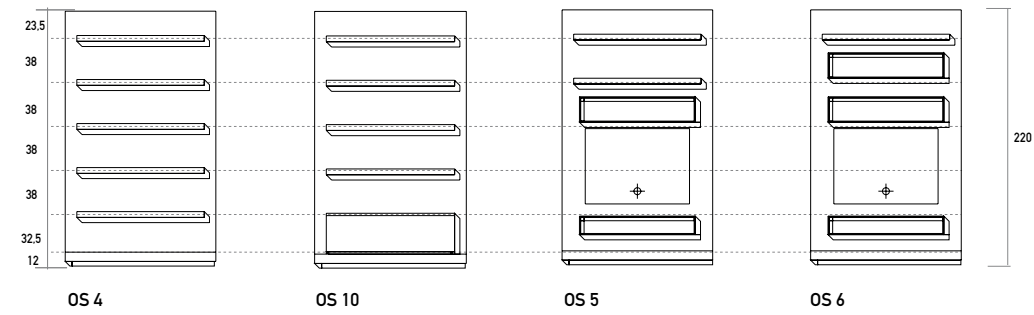

OS 4
L/W 130 H 220
W 51.2" H 86.7"

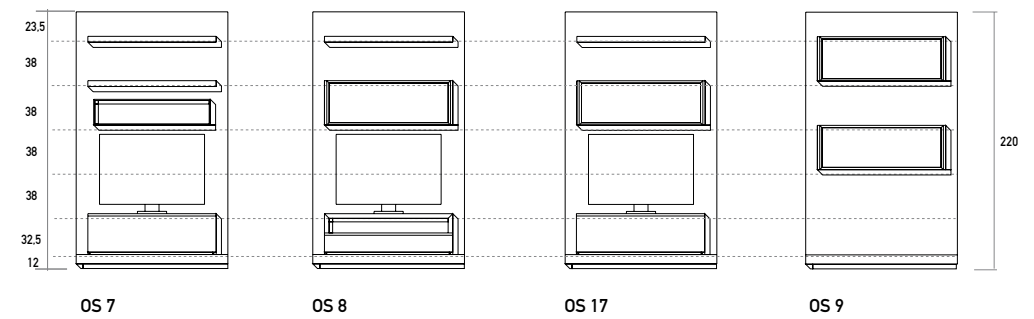

OS 7
L/W 130 H 220
W 51.2" H 86.7"

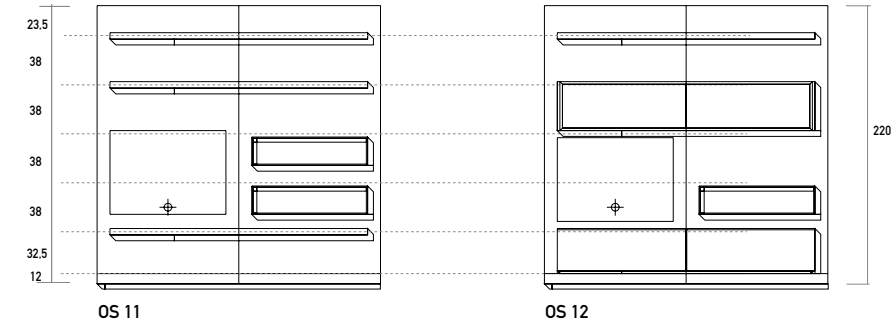

OS 11
L/W 220 H 220
W 86.7" H 86.7"

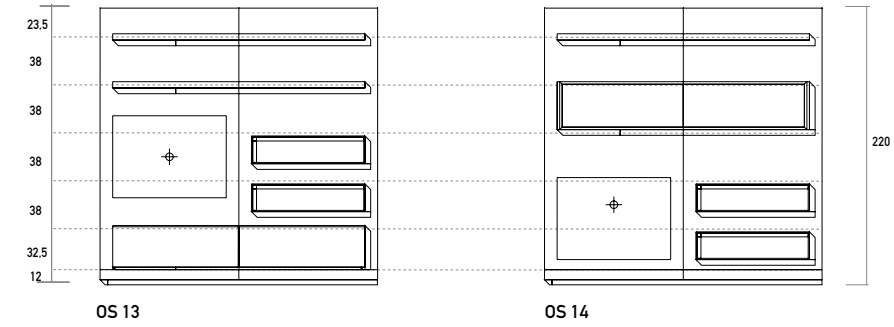

OS 13
L/W 220 H 220
W 86.7" H 86.7"

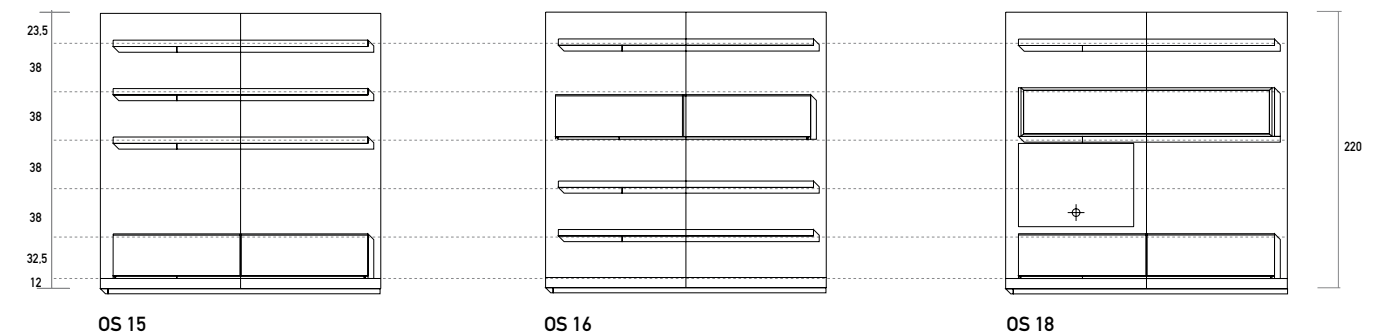

OS 15
L/W 220 H 220
W 86.7" H 86.7"

La natura è fonte inesauribile di ispirazione. L'alchimia dei materiali e dei colori trasforma la materia in bellezza. Sensazioni tattili e visive si amalgamano e danno vita ad arredi unici e inimitabili, fatti per rimanere belli nel tempo.

Nature is an inexhaustible source of inspiration. The alchemy of materials and colours transforms matter into beauty. Tactile and visual sensations blend together and give life to unique and inimitable furnishings, made to remain beautiful over time.

Materiali MATERIALS

Laccature per legno - Wood lacquers

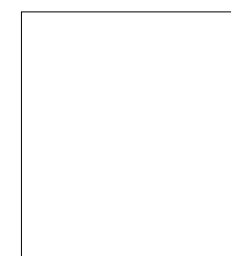

RAL 9016
Bianco lucido - opaco
Glossy - matt white

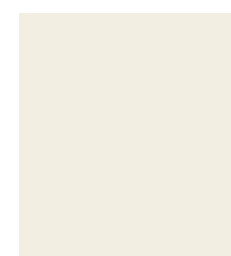

04.84
Crema lucido - opaco
Glossy - matt cream



D 050.70.10
Cipria lucido - opaco
Glossy - matt powder



15.65
Sabbia lucido - opaco
Glossy - matt sand



D 080.60.30
Senape lucido - opaco
Glossy - matt mustard



05.70
Tortora lucido - opaco
Glossy - matt dove brown



10.60
Corda lucido - opaco
Glossy - matt rope

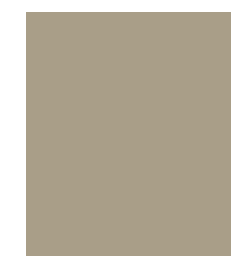

05.60
Grigio lucido - opaco
Glossy - matt grey



RAL 7006
Castoro lucido - opaco
Glossy - matt beaver



D 060.40.05
Fango lucido - opaco
Glossy - matt mud



D 220.60.10
Winter blue lucido - opaco
Glossy - matt winter blue



D 260.40.10
Lavanda lucido - opaco
Glossy - matt lavender



RAL 6033
Menta lucido - opaco
Glossy - matt mint



D 200.40.10
Alzavola lucido - opaco
Glossy - matt teal



RAL 6003
Verde lucido - opaco
Glossy - matt green



RAL 8004
Ruggine lucido - opaco
Glossy - matt rust



40.20
Rosso scuro lucido - opaco
Glossy - matt dark red



RAL 3007
Amaranto lucido - opaco
Glossy - matt amaranth



D 100.60.05
Grigio lucido - opaco
Glossy - matt grey



RAL 9005
Nero lucido - opaco
Glossy - matt black



100% Made in Italy
certificate N° IT01.IT_456.110.M
National register of Italian manufacturers

ALIVAR
ITALIAN DESIGN CULTURE

Alivar s.r.l

Via Leonardo da Vinci 118/14 - 50028

Barberino Tavarnelle FIRENZE Italy

tel. +39 055 8070115 fax +39 055 8070127

www.alivar.com

alivar@alivar.com

www.alivar.com