

# MICHELANGELO

Medea   
LIFESTYLE 1905

MADE IN ITALY

# MICHELANGELO

Medea   
LIFESTYLE 1905



## Michelangelo concept

La collezione Michelangelo di Medea Lifestyle 1905 richiama forme e materiali del passato, ma reinterpretati nelle forme, nelle proporzioni, nei materiali e nella tecnologia divenendo pezzi che vanno oltre le mode e gli stilismi. Il design di questi pezzi è ispirato all'arredo delle dimore alto borghesi milanesi degli anni trenta come Villa Necchi Campiglio disegnata da Piero Portaluppi o alle opere di Gio Ponti e Guglielmo Ulrich sempre di quegli anni. Questi autori facevano parte del movimento culturale ed artistico chiamato "Novecento" nato a Milano alla fine del 1922. Il Novecento ha come supremo riferimento l'antichità classica, la purezza delle forme e l'armonia nella composizione, ma questo amore per la tradizione viene contaminato dalla grande rivoluzione modernista e razionalista mittel europea della Bauhaus, di Walter Gropius e Mies van der Rohe. In questo modo le opere di quegli anni creano un equilibrio tra antico e moderno, tra innovazione e tradizione, tra rivoluzione e conservazione. La stessa filosofia è quella che caratterizza questi mobili.

The furniture Michelangelo collection of Medea Lifestyle 1905 recalls shapes and materials from the past, but reinterpreted in the shapes, proportions, materials and technology; becoming pieces ranging beyond fashion and trends. The design of these pieces is inspired by the furnishings of the Milanese bourgeois mansions of the thirties like Villa Necchi Campiglio designed by Piero Portaluppi or works of Gio Ponti and Guglielmo Ulrich always of those years. These authors were part of the cultural and artistic movement called "Novecento" born in Milan at the end of 1922. The twentieth century has as supreme reference the classical antiquity, purity of shapes and harmony in the composition. But this love of tradition is contaminated by the great modern and rational revolution of the Bauhaus of Walter Gropius and Mies van der Rohe in Central Europe. In this way the works of those years create a balance between old and new, between tradition and innovation, between revolution and conservation. The same philosophy characterizes this collection.



## SOFA

design  
**Matteo Nunziati**

Divano struttura in noce canaletto. Dettagli di metallo laccato oro satinato sul basamento. Rivestimento in tessuto o pelle.

Sofa structure in canaletto walnut. Metal details matt lacquered gold on basement. Upholstery fabric or leather.

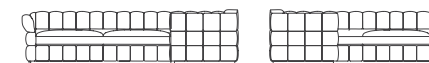

L 330/270 D 100 H 82 cm  
cod. **M1508**



## SOFA

design

**Matteo Nunziati**

Divano struttura in noce canaletto. Dettagli di metallo laccato oro satinato sul basamento. Rivestimento in tessuto o pelle.

Sofa structure in canaletto walnut. Metal details matt lacquered gold on basement. Upholstery fabric or leather.

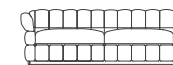

cod. **MI509**  
cod. **MI510**

L 250 D 100 H 82 cm  
L 200 D 100 H 82 cm



## ARMCHAIR

design  
**Matteo Nunziati**

Poltrona struttura in noce canaletto. Dettagli di metallo laccato oro satinato sulle gambe. Rivestimento in tessuto o pelle.  
 Armchair structure in canaletto walnut. Metal details matt lacquered gold on basement. Upholstery fabric or leather.

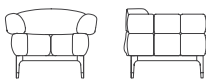

L 91 D 80 H 69 cm  
 cod. **MI501**



## SET OF SIDE TABLE

design  
**Umberto Asnago**

Set di 2 tavolini struttura noce canaletto.  
 Set of 2 tables structure in canaletto walnut.



L 36 D 41 H 45 cm  
 cod. **MI302**

L 36 D 41 H 56 cm  
 cod. **MI302**





## COFFE TABLE

design  
Matteo Nunziati

Tavolino da caffè struttura noce canaletto e due elementi laccati color oro satinato.  
Coffee table canaletto walnut structure and two elements matt lacquered gold.



L 75 D 75 H 33 cm  
cod. **M1304**



## SWIVEL BOOKCASE

design  
Matteo Nunziati

Libreria girevole struttura in noce canaletto. Parte interna di due elementi laccato oro satinato.  
Swivel bookcase structure in canaletto walnut. Internal part of two elements matt lacquered gold.

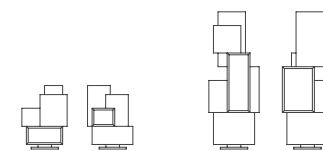

L 50 D 50 H 70 cm  
cod. **M1792**

L 55 D 60 H 150 cm  
cod. **M1791**





## TV CABINET

design  
**Matteo Nunziati**

Porta tv struttura noce canaletto, top marmo emperador, dettagli laccati color oro satinato.

Tv cabinet structure canaletto walnut, top marble emperador, Details matt gold lacquered colour.



cod. **MI601.M1** L 250 D 54 H 70 cm  
cod. **MI601.M2** L 190 D 54 H 55 cm





## TABLE

design  
**Matteo Nunziati**

Tavolo top in noce canaletto e gambe di metallo laccato color oro satinato.  
Table top in canaletto walnut and matt gold lacquered legs.

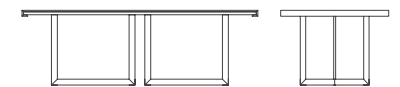

cod. **MI401.M1** L 240 D 110 H 76 cm  
cod. **MI401.M2** L 180 D 90 H 76 cm  
cod. **MI402** Ø 150 H 76 cm



## CHAIR

design  
**Umberto Asnago**

Sedia struttura in noce canaletto. Dettagli di metallo laccato oro satinato sulle gambe. Rivestimento in tessuto o pelle.

Chair structure in canaletto walnut. Legs with metal details matt lacquered gold. Upholstery fabric or leather.

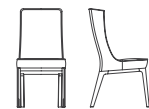

L 48 D 60 H 100 cm  
cod. **M1201**



## BAR CABINET

design  
**Umberto Asnago**

Mobile bar struttura noce canaletto e dettagli laccato oro satinato. Basamento in metallo laccato oro satinato.

Bar cabinet structure in canaletto walnut and matt gold lacquered details. Basement in metal lacquered matt gold.

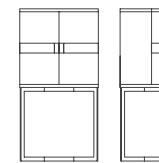

L 80 D 50 H 155 cm  
cod. **M1702**



## TABLE

design  
**Matteo Nunziati**

Tavolo top in noce canaletto e gambe di metallo laccato color oro satinato.  
Table top in canaletto walnut and matt gold lacquered legs.



Ø 150 H 76 cm  
cod. **MI402**



## BAR CABINET

design  
Matteo Nunziati

Mobile bar struttura noce canaletto, top marmo emperador, dettagli laccati color oro satinato, ante retrattili e interno con 1 anta e 3 cassetti.

Bar cabinet structure canaletto walnut, top marble emperador, details matt gold lacquered colour, retractable doors and internal part with 1 door and 3 drawers.

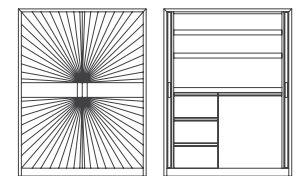

L 130 D 60 H 170 cm  
cod. **M1701**





## BED

design  
Matteo Nunziati

Letto struttura noce canaletto con testata imbottita rivestimento in tessuto o pelle. Dettagli di metallo laccato oro satinato sulle gambe.  
Misure interne: 193x203, 183x213, 200x200, 180x200 cm.  
Bed structure in canaletto walnut and upholstered headboard covered with fabric or leather. Legs with metal details matt lacquered gold.  
Internal size: 193x203, 183x213, 200x200, 180x200 cm.

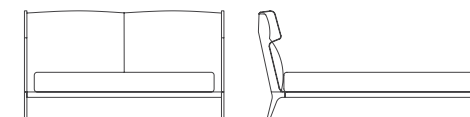

cod. **MI001.M1** L 220 D 230 H 110 cm  
 cod. **MI001.M2** L 200 D 230 H 110 cm  
 cod. **MI001.M3** L 213 D 233 H 110 cm  
 cod. **MI001.M4** L 203 D 243 H 110 cm





## BEDSIDE TABLE

design  
Matteo Nunziati

Comodino struttura in noce canaletto. Dettagli di metallo laccato oro satinato sulle gambe. Top in cuoio e cassetto legno.

Bedside table structure in canaletto walnut. Legs with metal details matt lacquered gold. Top in rawhide leather and drawer in wood.

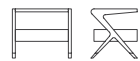

L 60 D 47 H 50 cm  
cod. **MI111**



## CHEST OF DRAWERS

design  
Matteo Nunziati

Comò struttura noce canaletto e dettagli di metallo laccato oro satinato. Top in cuoio. Cassetti in cuoio e legno.

Chest of drawers structure in canaletto walnut and metal corners lacquered matt gold. Top in rawhide leather. Drawers in rawhide leather and wood.

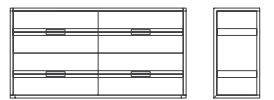

cod. **MI121.M1** L 150 D 59 H 92 cm  
cod. **MI121.M2** L 180 D 59 H 92 cm



## BED

design  
Matteo Nunziati

Letto con basamento legno, testata e giroletto imbottiti.  
Misure interne: 200x200, 180x200, 193x203, 183x213 cm.  
Bed with wooden basement, upholstered headboard and sides.  
Internal size: 200x200, 180x200, 193x203, 183x213 cm.

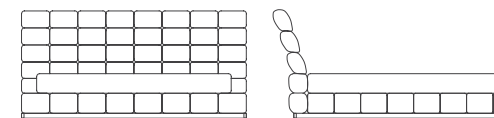

cod. <b>MI002.M1</b>	L 220 D 233 H 110 cm
cod. <b>MI002.M2</b>	L 200 D 233 H 110 cm
cod. <b>MI002.M3</b>	L 213 D 236 H 110 cm
cod. <b>MI002.M4</b>	L 203 D 246 H 110 cm



## BEDSIDE TABLE, TALLBOY

design  
Matteo Nunziati

Comodino e comò struttura legno e dettagli laccati oro satinato.

Bedside table and tallboy with wooden structure and gold lacquered details.



L 57 D 40 H 49 cm  
cod. **MI112**

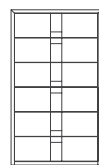

L 80 D 48 H 136 cm  
cod. **MI32.M1**



## CHEST OF DRAWERS

design  
Matteo Nunziati

Comò struttura legno e dettagli laccati oro satinato.

Chest of drawers with wooden structure and gold lacquered details.

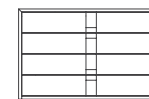

cod. **MI122.M1** L 140 D 52 H 87 cm  
cod. **MI122.M2** L 180 D 52 H 92 cm



## BENCH

design  
**Matteo Nunziati**

Panca struttura noce canaletto con seduta imbottita, rivestimento in tessuto o pelle. Dettagli di metallo laccato oro satinato sulle gambe.

Bench structure in canaletto walnut and upholstered seat cushion covered with fabric or leather. Legs with metal details matt lacquered gold.



L 150 D 45 H 47,5 cm  
cod. **MI101**



## COFFEE TABLE

design  
**Umberto Asnago**

Tavolino da caffè in noce canaletto.  
Coffee table in canaletto walnut.



L 102 D 116 H 38 cm  
cod. **MI303**



**LUXURY SHAPES  
AND MATERIALS FOR  
NEW SOPHISTICATED  
ATHMOSPHERE**



## BOOKCASE

design  
**Umberto Asnago**

Composizione libreria struttura in noce canaletto e rivestimento in cuoio, dettagli di metallo laccato color oro satinato.

Composition structure in canaletto walnut and inserts in rawhide leather, metal details matt lacquered gold.

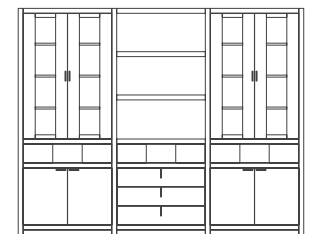

L 290 D 45 H 233 cm  
cod. **MI700**



## DESK

design  
**Matteo Nunziati**

Scrivania struttura in noce canaletto. Dettagli di metallo laccato oro satinato sulle gambe. Top in cuoio e cassetto legno.

Desk structure in canaletto walnut. Legs with metal details matt lacquered gold. Top in rawhide leather and drawer in wood.

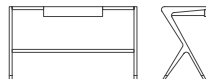

L 130 D 45 H 75 cm  
cod. **M1902**



## DESK CHAIR

design  
**Matteo Nunziati**

Sedia per scrivania struttura in noce canaletto. Dettagli di metallo laccato oro satinato sulle gambe. Rivestimento in tessuto o pelle.

Desk chair structure in canaletto walnut. Legs with metal details matt lacquered gold. Upholstery fabric or leather.



L 58 D 60 H 82 cm  
cod. **M1202**



## DESK

design

**Matteo Nunziati**

Scrivania struttura noce canaletto e inserti cuoio su top e frontali cassetti.

Dettagli laccati color oro satinato. Pannello di chiusura sul retro.

Desk canaletto walnut structure and rawhide leather insert on top and front drawers. Details matt lacquered gold. Modesty panel on the back.

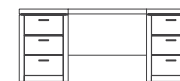

cod. **MI910.M1** L 160 D 70 H 76 cm

cod. **MI910.M2** L 180 D 90 H 76 cm





## SWIVEL ARMCHAIR

design  
**Umberto Asnago**

Poltrona girevole imbottita. Rivestimento in tessuto o pelle.

Upholstered swivel armchair. Upholstery fabric or leather.

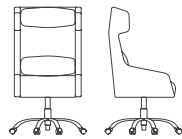

L 68 D 68 H 129 cm  
cod. **M1210**



## CHAIR

design  
**CRS Medea**

Sedia struttura in legno e rivestimento in tessuto o pelle.

Chair structure in wood and upholstery fabric or leather.



L 50 D 55 H 90 cm  
cod. **M1203**



**Michelangelo collections  
designed and coordinated by**

## **MATTEO NUNZIATI**

It was in 2000 that Matteo Nunziati opened his own firm, specializing in interior architectural design, in Milan. He has taught at the Domus Academy and the Taipei Industrial Design Department since 2004.

Globe-trotter and an eager researcher into trends and styles, between 2005 and 2006 he has specialized in the design of luxury hotels, wellness centers, spas and residential interiors in the United Arab Emirates and in particular in Dubai, allowing him to undertake projects in various parts of the world (Italy, USA, India, Qatar, Saudi Arabia, Kuwait, China and others). His projects, conceived to meet the highest aesthetic and technical quality standards, seek to achieve unique, luxury results in the form of living spaces with an intense dialogue between furniture, fittings and ornaments.

His love of travel, discovery and research have enabled Nunziati to build up a rich formal repertoire, sublimated into an original aesthetic which contains and expresses a variety of different design styles and languages.

He has received many major awards, special mentions and prizes, including the 2011 Good Design Award, the 2011 Wallpaper Design Award and the 2013 Cityscape Award, fuelling a career which also includes active partnerships with a large number of firms.

[www.matteonunziati.com](http://www.matteonunziati.com)

