

GeD CUCINE

Argento Vivo	<i>pag. 10</i>
Velvet	<i>pag. 20</i>
Seta	<i>pag. 34</i>
Space	<i>pag. 48</i>
Treviso	<i>pag. 62</i>
Fiamma	<i>pag. 72</i>
Life	<i>pag. 80</i>
Gioiosa	<i>pag. 88</i>
Technical info	<i>pag. 96</i>
Finishes	<i>pag. 100</i>

Argento Vivo

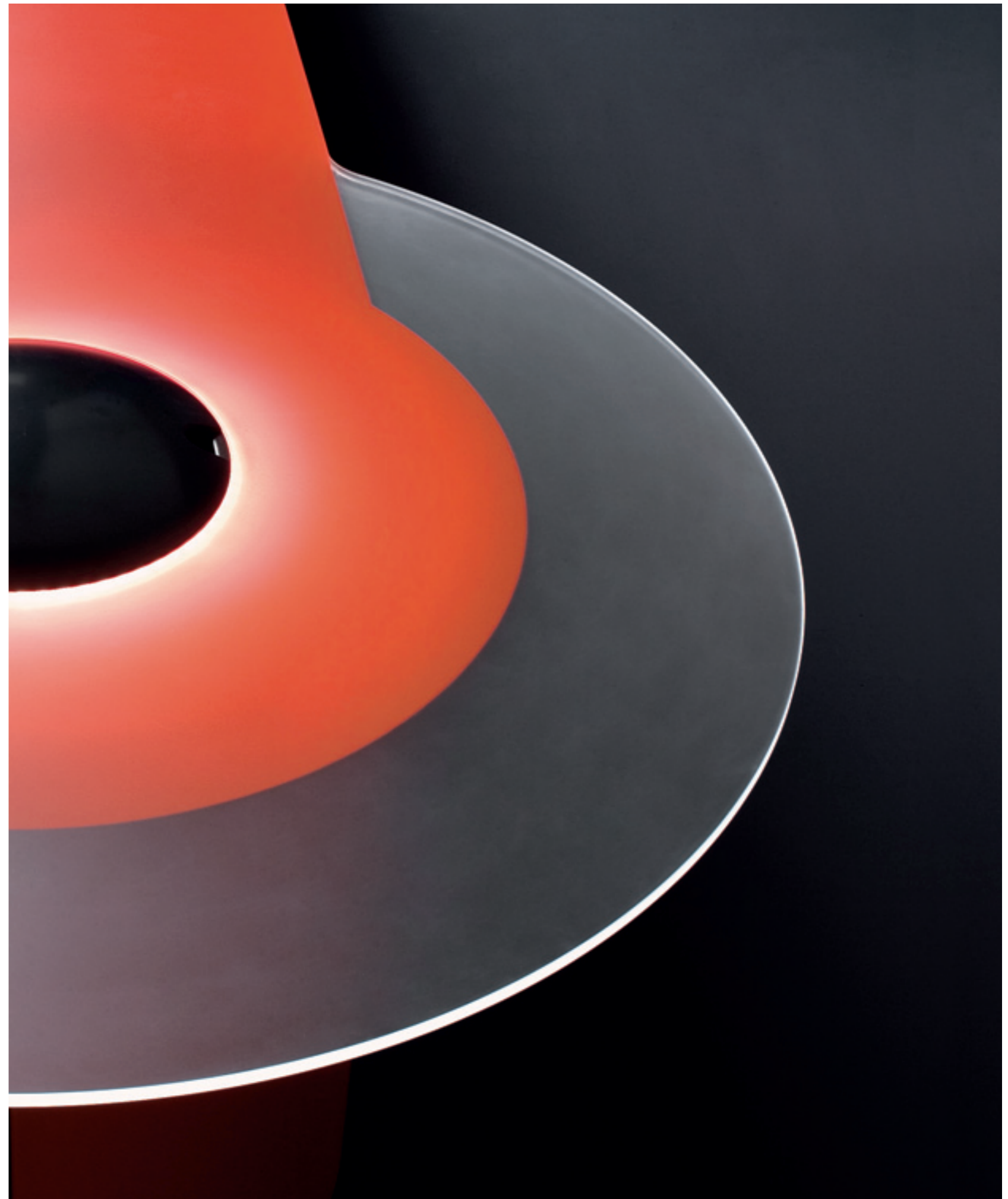





Sculpturally refined to its essential form, with crisp corner detailing and lean, long lines, Argento Vivo was designed by Roberto Pezzetta to provide the ultimate cooking and entertaining experience. Pezzetta brings to his first cabinet project, his years of experience designing kitchen appliances. Like a well conceived machine, the minimal thickness of the countertop combined with the reduced height of the toe kick maximizes the amount of interior storage. Tall curved glass cabinets act as a fully functional backdrop to a linear central island providing all kitchen necessities. A double sided prep area encourages multiple participants to clean and cook simultaneously, while a circular glass dining table with recessed wine cooler/fruit bowl, at the end, provides the appropriate hospitality. To aide the festive ambience, internal LED illumination around the wine cooler emits a warm glow. Argento Vivo comes in yellow, blue, green, orange or more classic white, black or silver, either matte or glossy. Clear glass countertops, which transmit the underlying color of the cabinetry are combined with a black Corian central work surface insert that blends seamlessly with cooktop and sink. In 2009 Argento Vivo received the Good Design Award from the Chicago Athenaeum.

Page 5, 6, 7, 8

Doors and countertops in orange lacquered tempered glass, sand-blasted finish. Center countertop in black Corian.







Page 12, 13, 14

Doors and countertops in white lacquered tempered glass, sand-blasted finish. Center countertop in black Corian.



Page 16, 17

Tall cabinets and peninsula in white lacquered tempered glass, sand-blasted finish. Center cabinets and wall cabinets in wenge wood. Countertops in black Corian.

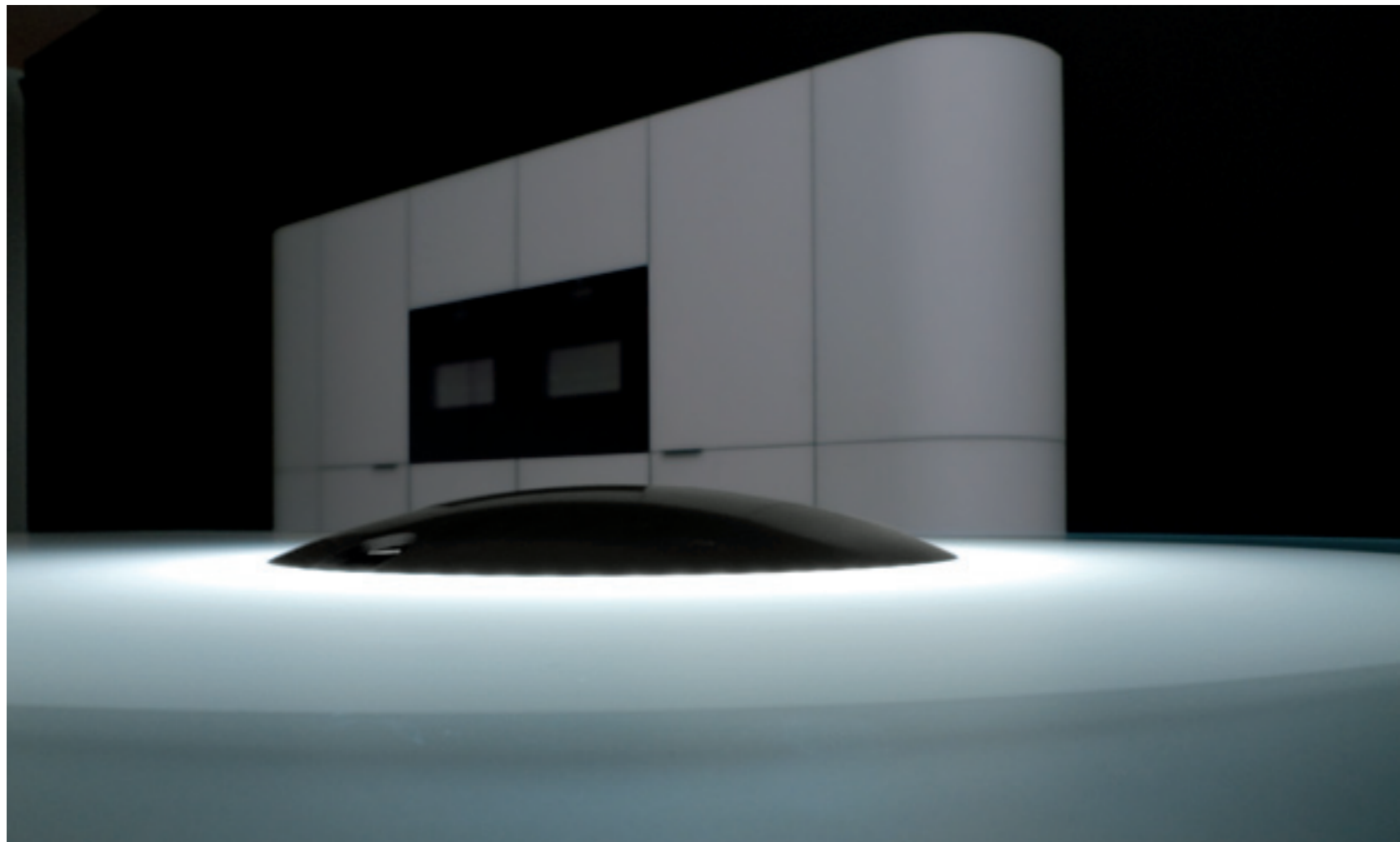

Velvet







Velvet features one of the most extensive cabinetry systems in the GeD Cucine repertoire. Within this range, one can create modern kitchens with uninterrupted runs of glass, lacquer, or natural woods, in a single material, or in unending combinations of colors, materials and textures emphasizing the sculptural effect of the storage volumes. Numerous glass and lacquer colors, both shiny and matte, range from ruby red to icy white, aquamarine and leaf green. Woods including Canaletto walnut, and oak, come in natural finish or various stains. The tempered glass doors are set into anodized aluminum frames with built in handle, to assure that glass edges don't get chipped. A version called Velvet SM features jewelry-like hardware.

Page 21

Doors and countertops in black lacquered tempered glass, gloss finish.

Page 22, 23

Doors in red lacquered tempered glass, gloss finish.
Countertops in white quartz, leather finish.

Page 24

Doors in yellow lacquered tempered glass, shiny finish.
Countertops and backsplash in black lacquered tempered glass, gloss finish.

Page 26, 27

Doors in Canaletto walnut. Countertops in white glacier Corian.







Page 28, 29

Doors (*island*) and boiserie in brown oak. Wall cabinets and tall cabinets (*right*) in polished white lacquer. Countertops in brown taupe quartz, polished finish.

Page 30

Doors (*island*) in white oak. Countertops in white quartz, polished finish.

Page 32

Doors in polished white lacquer. Countertops in white quartz, polished finish.



Seta







With a Zen-like, understated simplicity and ample storage, Seta allows a homeowner to cook in a soothing environment that enables food preparation and entertaining to be a more relaxing experience.

Flat doors offer a clean backdrop for a variety hardware profiles including a recessed pull that virtually disappears in a linear composition along the top or bottom of the drawers or cabinets. With its ample enclosed storage, both floor standing and wall hung, Seta can be customized with combinations of matte and glossy finish materials in a variety of colors and woods. An exclusive rough saw textured oak, called "seghettato" offers a tactile texture that is particularly appealing when contrasted by a smooth lacquer in a choice of 19 colors.

By creative combination of finishes, storage pieces and colors, architects and designers can create what is essentially a custom environment made through a rigorous, mechanized production process that assures top quality and consistency from order placement to final installation.

Page 36, 41

Doors in polished white lacquer. Countertops in dark brown quartz, matte finish.

Page 38, 40

Doors in brown oak. Countertops in dark brown quartz, matte finish.







Page 42, 43, 44, 46

Doors in yuta oak, rough saw texture. Countertops in "White Rock" Unicolor laminate. Backsplash in brushed s/steel.

Page 47

Doors (*island*) in natural oak. Wall kitchen and tall cabinets in white matte lacquer. Countertops and table in White Unicolor laminate, matte finish.



Space







Space offers an efficient kitchen solution with maximized storage, ergonomic functionality and aesthetic beauty within the confines of a minimized foot print. High tech laser cut cabinetry reduces raw material usage and produces a refined lacquer finish in glossy white or beige that seamlessly envelopes visible panels. The streamlined design features a recessed profile handhold, in aluminum or glossy white, to open doors and drawers. Adding texture to the design, cabinets can also be made of a solid, rough saw "seghettato" wood in white oak, tobacco or moka. Countertops are offered in a unique laminate with a stone or textile-like texture.

Page 49, 50, 51

Doors in white laminate, gloss finish. Countertops in "White Rock" Unicolor laminate.

Page 52

Doors in white oak laminate, rough saw texture. Countertops in "Black Rock" Unicolor laminate.

Page 53

Doors in washed oak laminate, rough saw texture. Countertops in "White Rock" Unicolor laminate.







Page 56, 57

Doors (*base cabinets and tall cabinets*) in tabacco oak laminate, rough saw texture. Doors (*wall cabinets*) in white matte lacquer. Countertops in "White Rock" Unicolor laminate.

Page 58

Doors and top panel in white matte lacquer.

Page 60

Tabacco oak laminate, rough saw texture. Recessed profile in s/steel finish.

Page 61

Solid oak table and stool, white painted.



Treviso







Treviso, home town of GeD Cucine, brings to mind ancient architecture, the tastes and smells of classic Italian cooking, and the gathering of family and friends. This kitchen most thoroughly proposes the linking of living and dining areas through an architectural approach combining cabinets in a multiple of heights that will work throughout the home. Tables that run off cabinets divide space and create gathering areas. A steel work surface hides the sink behind a sliding metal panel for post-prandial viewing. Classic, yet modern, Treviso has tactile wood fronts in graphite or natural oak, or teak, thickly framed on three sides, with handles carved directly into the surface. Cabinets combine open shelving and ample closed storage to create an environment that is both functional and inviting.

Page 63, 64, 65, 68, 71

Doors in white painted oak. Countertops and backsplash in brushed s/steel.

Page 66

Doors in white painted oak. Countertops and backsplash in brushed s/steel. Dining tables in polished white lacquer.

Page 69

Treviso doors with solid oak frame and carved handle, white oak finish.



Page 70:
Countertop in brushed s/steel with sliding cover for sink.



Fiamma







The warmth of sepia-toned walnut merges with clean, modern lines to create Fiamma, or flame, a kitchen designed by Giancarlo Fabro, that easily becomes the heart of a home.

Characterized by the wide, horizontal, almost slatted banding of the walnut, this kitchen combines living and dining areas through cabinetry featuring two-level work surfaces and capacious drawers and shelving behind unbroken wood expanses. Intelligent storage options for plates, cookware and appliances help maintain a calm, clutter free environment.

Doors feature thin metal, or wood and metal handles that contribute to the overall well being of this design.

Page 73

Doors in grey walnut. Countertops and backsplash in Biancone stone, honed finish.

Page 74, 75

Doors in grey walnut. Countertops and backsplash in Porphyry stone, honed finish.

Page 76

Doors and countertops in grey walnut.

Page 79

Sliding door storage system.



Life







Life keeps in balance functional practicality and beauty in the kitchen. Recessed door pulls, seamlessly inserted into smooth door fronts, are both pleasant to the touch and easy to clean; unbroken lines in cabinet fronts are maintained by this unobtrusive horizontal detail. A rigorously modular design allows for myriad possibilities, while lacquer-like laminate finishes on vertical surfaces are numerous and include both matte and glossy textures in white, pine and ruby red. Counters and backsplashes are offered in a selection of embossed wood- and stone-like laminates.

Page 81

Doors in red laminate, gloss finish. Countertops in "Brown Rock" Unicolor laminate.

Page 82, 83

Doors in white laminate, matte finish. Countertops in "White Rock" Unicolor laminate. Boiserie in grey oak.

Page 84

Doors in white laminate, matte finish. Countertops in White Rock" Unicolor laminate.

Page 87

Corner cabinet system.



Gioiosa







GeD Cucine moves on once more respecting the combination of tradition and modernity that has been its trademark in the industry. Doors surfaces, countertops and all the accessories are made with perfectly harmonious depths. The high relief surfaces and the quality of the lacquered finishes provide Gioiosa by GeD Cucine with a generous look and delicate feeling of pleasant wellness.

Page 90, 91, 92

Doors in brown painted ash-wood. Countertops in "Black Rock" Unicolor laminate.

Page 94, 95

Doors in cream painted ash-wood. Countertops in "Brown Rock" Unicolor laminate.



Technical info

Base cabinets:

depth: 14 1/4", 23 5/8", 25 1/2", 27 1/2", 31 1/2" height: 14 1/4", 23 5/8", 28 3/4", 33" (Argento Vivo only)

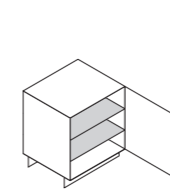

1 door, 2 shelves
w 5 7/8", 7 7/8", 12", 15 3/4",
18", 23 5/8"

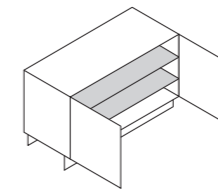

2 doors, 2 shelves
w 31 1/2", 35 1/2", 47 1/4"

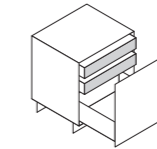

*1 heavy-duty drawer, 2 internal
drawers* w 5 7/8", 12", 18",
23 5/8", 35 1/2", 47 1/4"

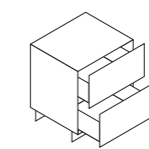

2 heavy-duty drawers
w 18", 23 5/8", 35 7/8",
47 1/4"

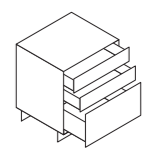

2 drawers, 1 heavy-duty drawer
w 18", 23 5/8", 35 7/8",
47 1/4"

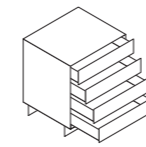

4 drawers
18", 23 5/8", 35 7/8", 47 1/4"

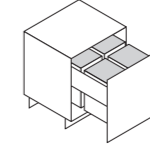

*1 heavy-duty drawer with
full-height waste bins*
w 18", 23 5/8"

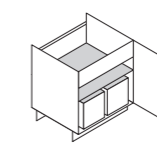

*sink unit, 1 heavy-duty drawer
with built-in waste bins*
w 18", 23 5/8", 35 1/2", 47 1/4"

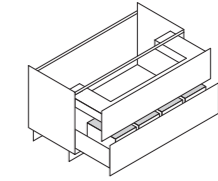

*1 sink-shaped drawer, 1 heavy-duty
drawer with built-in waste bins*
w 35 7/8", 47 1/4"

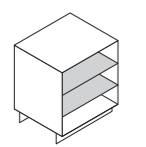

1 open-faced unit
w 5 7/8", 7 7/8", 12", 15 3/4",
18", 23 5/8"

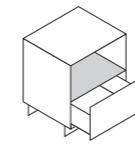

*1 open-faced unit,
1 heavy-duty drawer*
w 23 5/8", 35 1/2", 47 1/4"

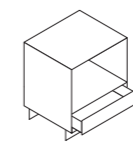

1 oven unit, 1 drawer (optional)
w 23 5/8", 30", 36"

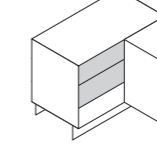

corner unit, 1 door, shelves
w 35 1/2", 41 1/4"

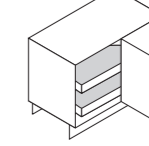

*corner unit, 1 door,
revolving metal shelves*
w 35 1/2", 41 1/4"

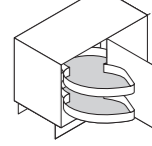

corner unit, 1 door, pull-out trays
w 35 1/2", 41 1/4"

Tall cabinets:

depth: 23 5/8", 25 1/2" height: 38", 52"

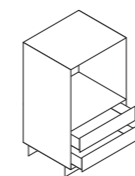

1 oven unit, 2 drawers
w 23 5/8", 30", 36"

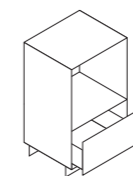

1 oven unit, 1 drawer (optional)
w 23 5/8", 30", 36"

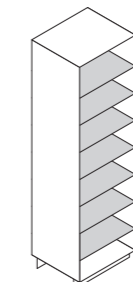

1 open-faced unit
w 5 7/8" - 23 5/8"

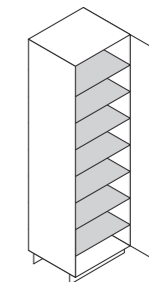

1 door, shelves
w 12", 18", 23 5/8"

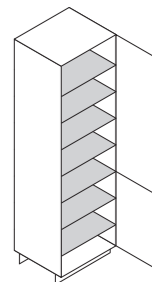

2 doors, shelves
w 12", 18", 23 5/8"

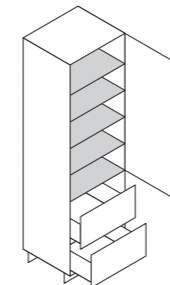

1 door, 2 heavy-duty drawers
w 18", 23 5/8"

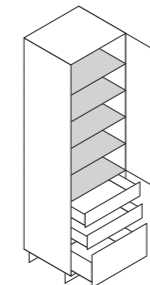

1 door, 2 drawers, 1 heavy-duty drawer
w 18", 23 5/8"

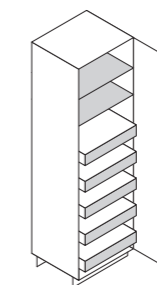

1 door, internal trays
w 18", 23 5/8"

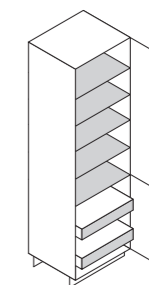

2 doors, internal trays
w 18", 23 5/8"

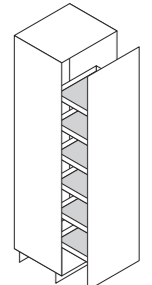

1 pull-out door w/tray system
w 12", 18", 23 5/8"

Tall cabinets:

depth: 23 5/8", 25 1/2" height: 38", 52"

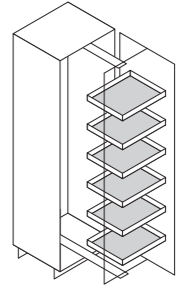

1 pull-out door w/revolving trays
w 5 7/8" - 23 5/8"

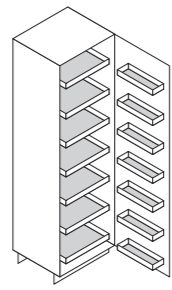

1 door w/sliding trays
w 12", 18", 23 5/8"

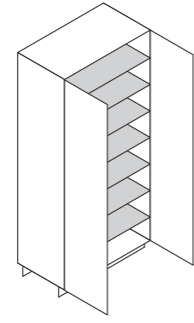

2 doors, shelves
w 35 7/8"

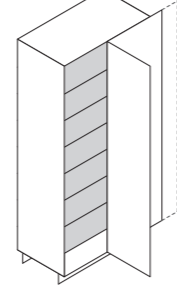

corner unit, 1 door, shelves
w 35 1/2", 41 1/4"

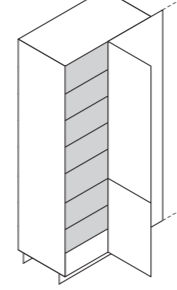

corner unit, 2 doors, shelves
w 35 1/2", 41 1/4"

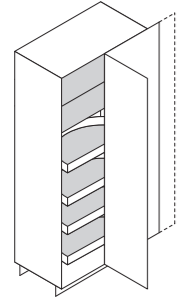

corner unit, 1 door, revolving metal shelves
w 18", 23 5/8"

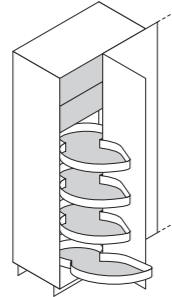

corner unit, 1 door, pull-out trays
w 18", 23 5/8"

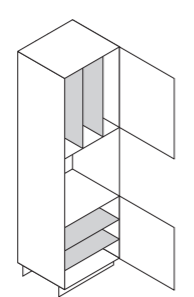

1 oven unit, 2 doors, shelves, trays holder
w 23 5/8", 27 1/2", 30", 36"

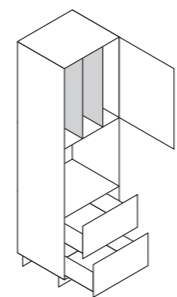

1 oven unit, 2 heavy-duty drawers
w 23 5/8", 27 1/2", 30", 36"

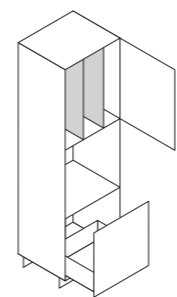

1 oven unit, 1 door, 1 heavy-duty drawer
w 23 5/8", 27 1/2", 30", 36"

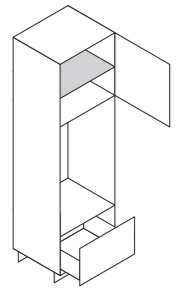

1 double oven unit, 1 heavy-duty drawer
w 23 5/8", 27 1/2", 30", 36"

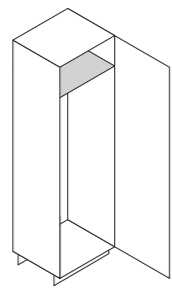

1 fridge/freezer unit, 1 door
w 23 5/8"

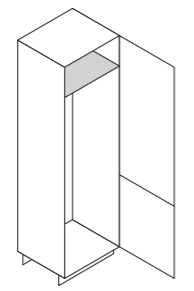

1 fridge/freezer unit, 2 doors
w 23 5/8"

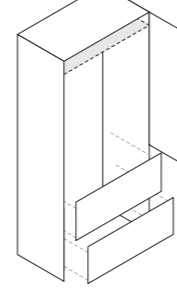

1 refrigerator combi unit, 2, 3 or 4 doors
w 23 5/8", 27 1/2", 30", 36"

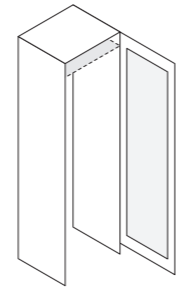

1 wine cooler unit, 1 door
w 23 5/8", 30"

Wall cabinets:

depth: 14 1/4" height: 23 5/8", 28 3/8", 38", 40 1/4" (Argento Vivo only), 47 1/4"

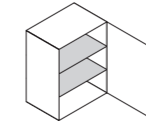

1 door, shelves
5 7/8", 12", 15 3/4", 18", 23 5/8"

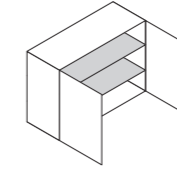

2 doors, shelves
w 31 1/2", 35 1/2", 47 1/4"

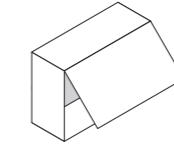

1 flap door, shelves
w 23 5/8", 35 1/2", 47 1/4", 59", 71" (h 23 5/8" only)

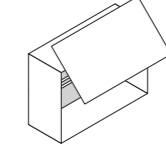

1 flap-over door, shelves
(h 23 5/8", 28 3/8" only)
w 23 5/8", 35 1/2", 47 1/4"

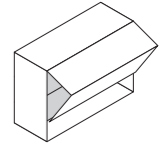

1 folding door, shelves
(h 28 3/8" only) w 23 5/8", 35 1/2"

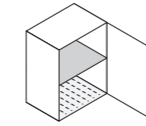

1 door, drainer
w 18", 23 5/8"

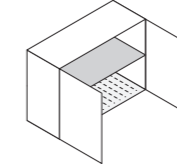

2 doors, drainer
w 31 1/2", 35 1/2"

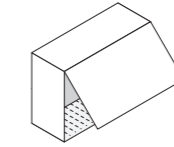

1 flap-over door, drainer
(h 23 5/8", 28 3/8" only)
w 23 5/8", 35 1/2", 47 1/4"

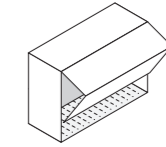

1 folding door, drainer
(h 28 3/8" only)
w 23 5/8", 35 1/2"

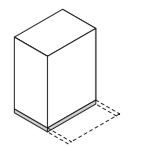

built-in hood unit,
1 or 2 doors, shelves
w 23 5/8", 30", 35 1/2"

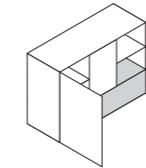

concealed hood unit, 1 or 2 doors, shelves
w 23 5/8", 30", 35 1/2", 47 1/4"

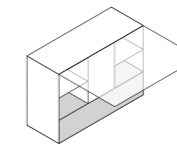

concealed hood unit,
1 flap door (h 23 5/8" only)
w 35 1/2", 47 1/4"

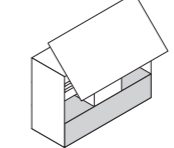

concealed hood unit, 1 flap-over door
(h 28 3/8" only) w 23 5/8", 30", 35 1/2", 47 1/4"

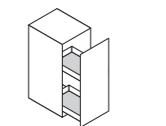

1 pull-out door with rack
w 5 7/8"

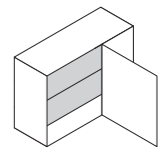

corner unit, 1 door, shelves
door w 12", 18", 23 5/8", 35 1/2", 47 1/4"

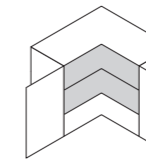

corner unit, 2 doors, shelves
doors w 12", 18", 23 5/8"

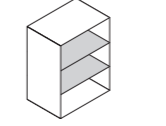

open-faced unit, shelves
w 5 7/8" - 23 5/8"

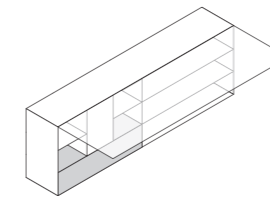

concealed hood unit, 1 flap door, shelves
(h 23 5/8" only) w 59", 71"

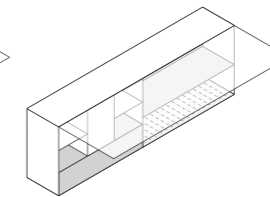

concealed hood unit, drainer, 1 flap door
(h 23 5/8" only) w 59", 71"

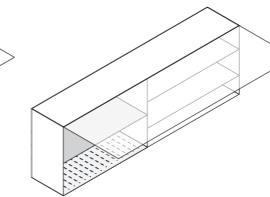

1 flap door, drainer, shelves
(h 23 5/8" only) w 59", 71"

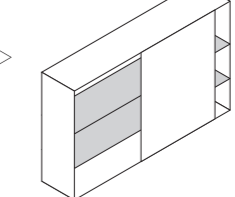

open-faced unit w/sliding door
w 47 1/4", 70 7/8"

Finishes



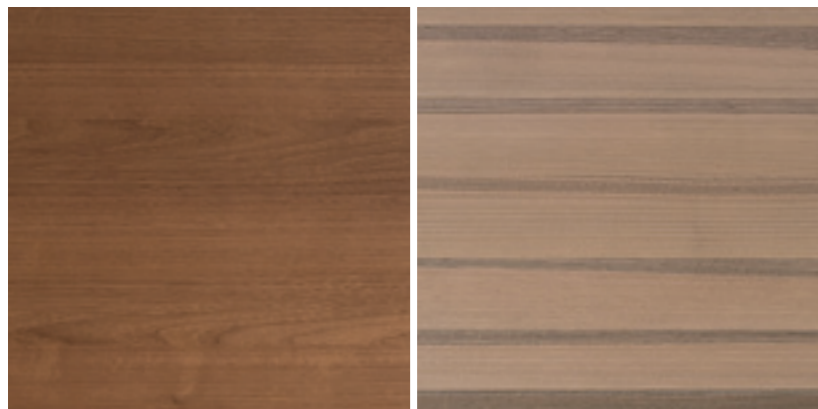

<p><i>Oak</i> natural finish</p>	<p><i>Oak</i> Juta (dye finish) Also available in "rough saw texture"</p>	<p><i>Oak</i> Tabacco (dye finish) Also available in "rough saw texture"</p>	<p><i>Oak</i> Moka (dye finish)</p>
<p><i>Oak</i> Ash grey (dye finish) Also available in "rough saw texture"</p>	<p><i>Oak</i> Dark brown (dye finish)</p>	<p><i>Oak</i> Graphite (dye finish)</p>	
<p><i>Canaletto walnut</i> natural finish</p>	<p><i>Grey walnut</i> natural finish</p>		

Wood veneer: oak woods are available for Velvet and Seta collections. Natural oak and graphite oak are available also for Treviso collection. Canaletto walnut is available for Velvet and Fiamma collections. Grey walnut is only available for Fiamma collection.



White oak
painted finish

Linen oak
painted finish

Ivory oak
painted finish

Coral oak
painted finish

Mink oak
painted finish

Rope oak
painted finish

White ash-wood
painted finish

Beige ash-wood
painted finish

Madreperla ash-wood
painted finish

Moss grey ash-wood
painted finish

Tabacco ash-wood
painted finish

Wood veneer: painted oak woods are available for Velvet and Seta collections. *Solid ash-wood:* only available for Gioiosa collection.



Matrix
Spring walnut

Matrix
Cherry

Grafis
Guerrilla grey

Grafis
Sand

Grafis
Ecrú

Rough saw texture
White oak

Rough saw texture
Washed oak

Rough saw texture
Tabacco oak

Rough saw texture
Moka oak

Laser
matte white

Laser
glossy white

Laser
glossy beige

Laminate: available for Space and Energy collections.



<i>9016</i> White	<i>58</i> Ivory	<i>81</i> Sand	<i>32.4</i> Vanilla	<i>32.1</i> Saffron
<i>2000</i> Tangerine	<i>3000</i> Blazing red	<i>3004</i> Purple red	<i>1019</i> Maron glace	<i>8025</i> Cacao
<i>9018</i> Papyrus grey	<i>7030</i> Stone grey	<i>7023</i> Dove grey	<i>7039</i> Quartz grey	<i>7016</i> Anthracite grey
<i>9005</i> Dark black	<i>74</i> Acquamarine	<i>5005</i> Night blue	<i>5002</i> Ultramarine blue	

Lacquer: available in polished and matte finish. Available for Velvet, Seta and Space collections.



<i>Gloss/matte finish</i> White	<i>Gloss/matte finish</i> Dove gray	<i>Matte finish</i> Magnolia	<i>Gloss/matte finish</i> Yellow sun	<i>Gloss/matte finish</i> Navy blue
<i>Gloss/matte finish</i> Gunmetal gray	<i>Gloss/matte finish</i> Black	<i>Wood grain</i> Brushed gray oak	<i>Wood grain</i> Light oak	<i>Wood grain</i> Dove gray ash-wood
<i>Wood grain</i> Brushed moka oak	<i>Wood grain</i> White ash-wood	<i>Gloss finish</i> Cream	<i>Gloss finish</i> Orange	<i>Gloss finish</i> Red
<i>Gloss finish</i> Ruby red	<i>Gloss finish</i> Aubergine	<i>Gloss finish</i> Vintage green	<i>Gloss finish</i> Pistachio	<i>Gloss finish</i> Periwinkle blue
<i>Brushed finish</i> Aluminum	<i>Gloss finish</i> Anthracite	<i>Wood grain</i> White pine	<i>Wood grain</i> Moka pine	

Polymeric: available for Life collection.